

SPECIFICATIONS:

CONSTRUCTION:

12 Gauge steel cabinet finished with Powder-Coat Finish, Includes hopper and stand, removable endcaps for easy access to filters, pressure gauge to indicate filter changes, and automatic cleaning. Also included is a direct drive motor/blower assembly, Motor starters/disconnects NOT INCLUDED.

WEIGHT:

1730 lbs.

AIRFLOW:

See chart below

NOISE:

See chart "A"

ELECTRICAL:

- 5 HP 208/230/460/3/60, 12.0/6.0 amps, BI blower, std.
- 7.5 HP 208/230/460/3/60, 17.2/8.6 amps, BI blower, opt.
- 10 HP 208/230/460/3/60, 24.0/12.0 amps, High press., opt.
- 10 HP 208/230/460/3/60, 24.0/12.0 amps, High flow, opt.

FIRE SUPPRESSION:

Equipment provided by others.

MAIN FILTERS:

- (12)16"Diameter cartridges, CLEAN 2, std.
- (12)16"Diameter cartridges, FiberDust, opt.

HEPA OPTION:

- External HEPA filter, 99.97% (2000 CFM)
- External HEPA filter, 99.97% (4000 CFM)

AD OPTION:

- (2) External adsorbers, 50 lbs., refillable, followed by a 2" poly afterfilter (2000 CFM)
- (2) External adsorbers, 50 lbs., refillable, followed by a 2" poly afterfilter (4000 CFM)

OTHER OPTIONS:

- 55 Gallon lld/hose
- Slide gate
- 50 Hz
- 575 Volt
- Silencer
- Explosion vent door

SPECIAL NOTES:

Compressed air filter provided by others.

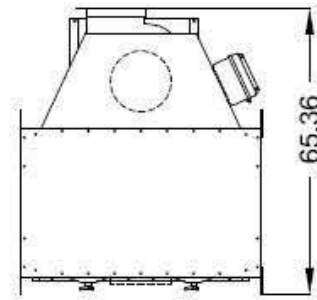

TOP VIEW

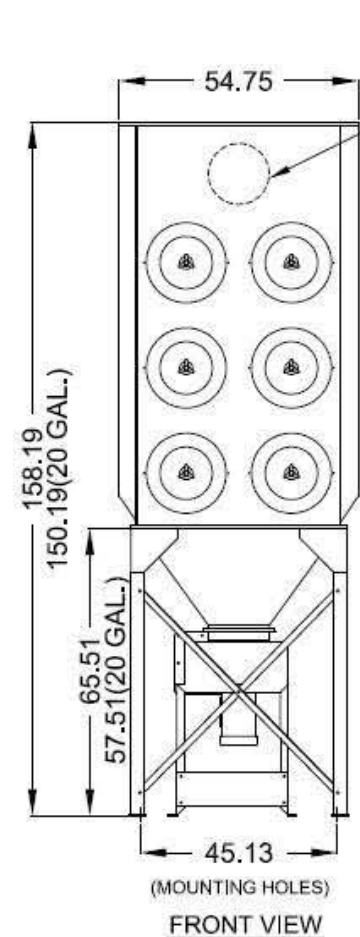
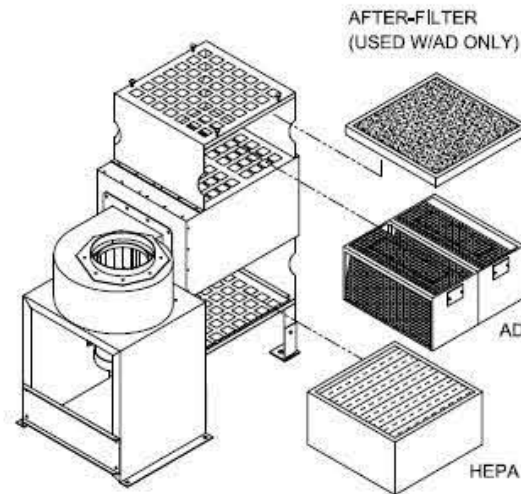

FRONT VIEW

CUSTOMER TO SPECIFY INLET SIZE AND LOCATION (UP TO 22" FRONT, BACK OR TOP, 21" SIDES)

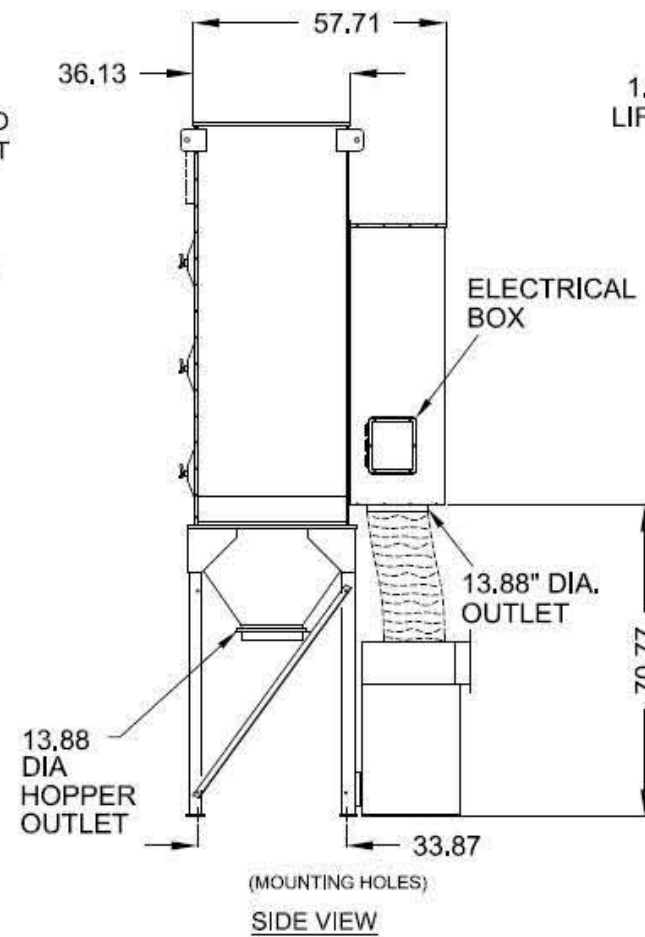

SIDE VIEW

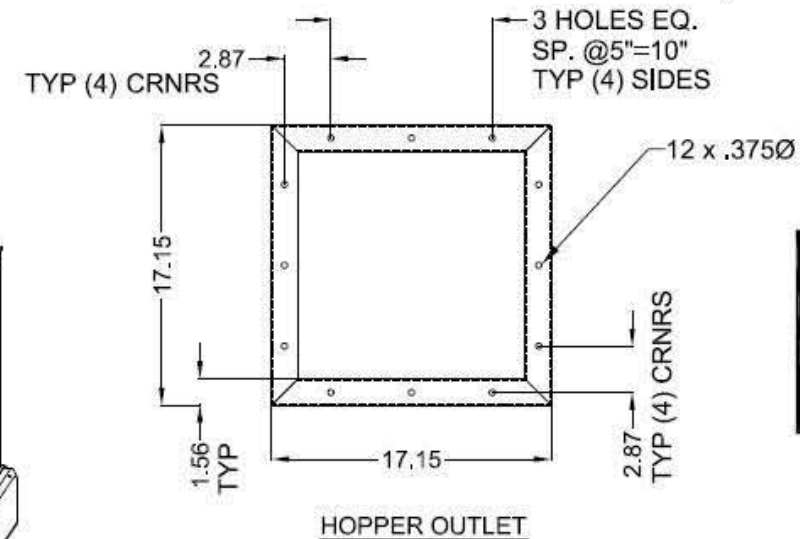
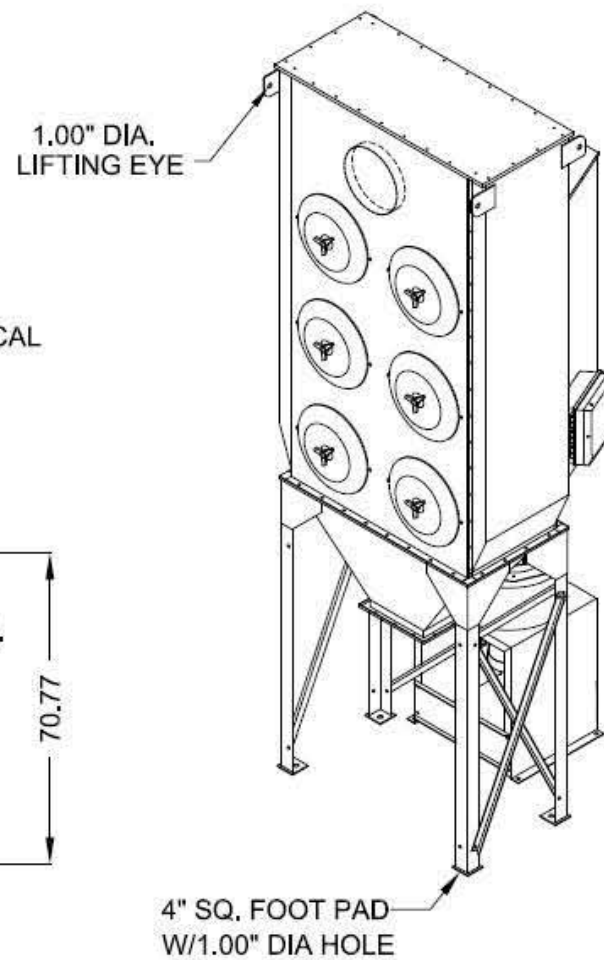

HOPPER OUTLET

CHART "A"

MOTOR/BLOWER OPTION	dBA	dBA WITH SILENCER
5 HP, BI	84	75
7.5 HP, BI	84	75
10 HP	89	78

MOTOR/BLOWER OPTION	"wg EXTERNAL ADDED STATIC									
	1	2	3	4	5	6	7	8	9	10
5 HP, BI	3550	3350	3075	2700	2275	1700	—	—	—	—
7.5 HP, BI	4950	4800	4550	4250	3875	3300	2500	—	—	—
10 HP, HP	5500	5375	5250	5100	4950	4750	4550	4350	4100	3850
10 HP, HF	6800	6550	6150	5950	5650	5400	4900	4400	3800	—
20 HP	15000	14500	13800	13200	12500	11700	10800	9300	—	—
25 HP	17000	16600	16000	15500	15000	14200	13200	12500	11200	10000

CUBIC FEET PER MINUTE (CFM)

04-06

CUSTOMER:
 CUSTOMER P.O.:
 PROJECT:
 ENGINEER:
 SALES REP.:
 IDENTIFICATION / TAGGING:

> www.lev-co.com • 1.888.862.5356

lev-co

The device depicted and described hereon embodies proprietary information owned by the manufacturer. All design, manufacturing, reproduction, sales and patent rights regarding this device or drawing reserved except where explicit right is guaranteed in writing. We reserve the right to make design changes.

Drawn by: Janos B
 Date: 6/1/2009
 Scale: NTS
 Weight: N/A

04-06 DC-18
CARTRIDGES DUST COLLECTOR
 Specification Drawing

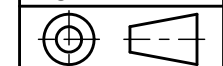

Drawing No.: -
 Material: -
 File Name: (04-06) DC-18 - SD
 Sheet: 1/2

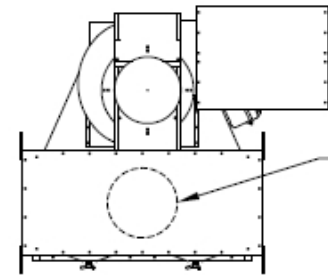

CUSTOMER TO SPECIFY INLET SIZE AND LOCATION (UP TO 22" FRONT, BACK OR TOP, 21" SIDES)

TOP VIEW

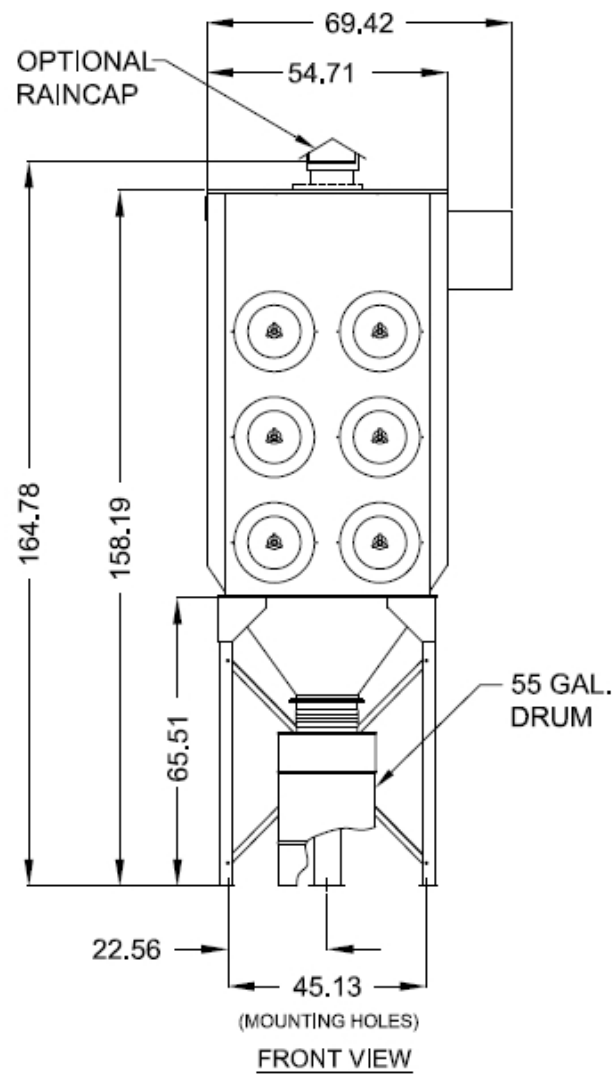

FRONT VIEW

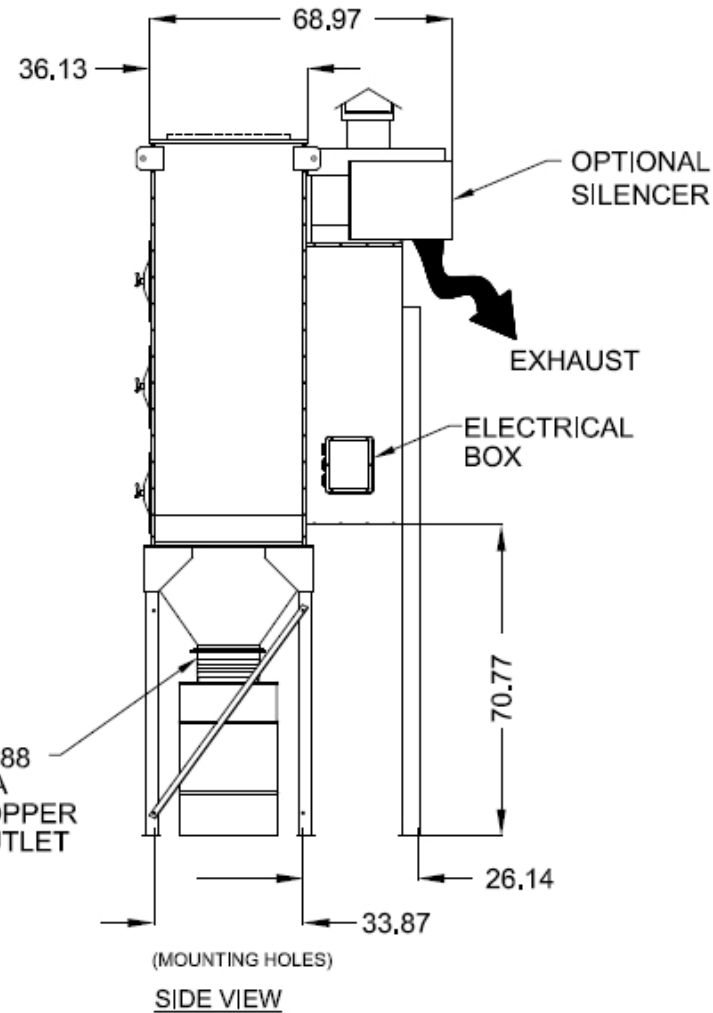

SIDE VIEW

MODELS & OPTIONS:

Part # Description

Main System / Part

- DC-18 Cartridge dust collector with (18) CLEAN 2@ cartridge filters, floor mounted 5 HP 208/230/460/3/60 BI Blower (12/6 amps) and block-off components for on-line cleaning. Motor starters/disconnects not included.

Fan / Motor Upgrades or Options (when ordering main unit)

- DC-18-25HP-BI 25 HP TEFC motor, 208-230/460/575/3/60Hz, high flow blower; Replaces 5 HP blower/motor (Adds 250 lbs. to ship weight).
- DC-18-10HP-HF 10 HP TEFC motor, 208-230/460/575/3/60Hz, high flow blower; Replaces 5 HP blower/motor (Adds 150 lbs. to ship weight).
- DC-18-10HP-HP 10 HP TEFC motor, 208-230/460/575/3/60Hz, high pressure blower; Replaces 5 HP blower/motor (Adds 150 lbs. to ship weight).
- DC-18-7.5HP-BI 7.5 HP TEFC motor, 208-230/460/575/3/60Hz, with backward incline blower; Replaces 5 HP blower/motor (adds 55 lbs. to ship weight).
- DC-18-LESSBLOWER Delete standard 5 HP motor/blower.
- DC-18-TOPMOUNT Option for top mounting all blower options for DC-18.

Filter Options (when ordering main unit)

- DC-18-EXT-AD4 External adsorption option: (4) refillable, v-bank adsorber modules, 100 lbs. capacity; rated at 4000 cfm. Order charcoal separately. (Includes S-BI silencer option.)
- DC-18-EXT-HE4 External HEPA option: (2) 99.97% HEPA filters; rated at 4000 CFM. (Includes S-BI silencer option.)
- DC-18-FD Eighteen (18) FIBERDUST@ cartridges in place of CLEAN-2@ cartridges.
- DC-18-UCP Eighteen (18) ULTRACLEAN-PLUS™ cartridges in place of CLEAN-2@ cartridges.

Preventative Maintenance Pressure Gauges, etc. (when ordering main unit)

- DC-18-PG-10 0-10" magna-helic pressure gauge, approximately 5" diameter size. Surface mounted.

Misc. Options

- DC-18-EXPVENT Explosion vent door. (Adds 30 lbs. to ship weight.)
- DC-18-HOPPER-20 Standard hopper with 20 gallon container and 54" tall legs (Unit height increases to 212").
- DRUM-45 45 imperial gallon (55 US gallons) steel drum c/w lid.

Sound Attenuation

- DC-18-S-BI Exhaust silencer for 5 HP, 7.5 HP and 10 HP backward incline blowers.

Installation Option & Accessories

- DC-18-GATE Slide gate, attaches to hopper outlet; facilitates drum change out.
- DC-18-RS Rain shield on blower outlet.

04-06

CUSTOMER:
 CUSTOMER P.O.:
 PROJECT:
 ENGINEER:
 SALES REP.:
 IDENTIFICATION / TAGGING:

> www.lev-co.com • 1.888.862.5356

lev-co

The device depicted and described hereon embodies proprietary information owned by the manufacturer. All design, manufacturing, reproduction, sales and patent rights regarding this device or drawing reserved except where explicit right is guaranteed in writing. We reserve the right to make design changes.

Drawn by: Janos B
 Date: 6/1/2009
 Scale: NTS
 Weight: N/A

04-06 DC-18
CARTRIDGES DUST COLLECTOR
 Specification Drawing

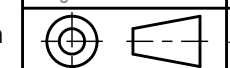

Drawing No.: - File Name: (04-06) DC-18 - SD
 Material: - Sheet: 2/2