

**SPECIFICATIONS:**

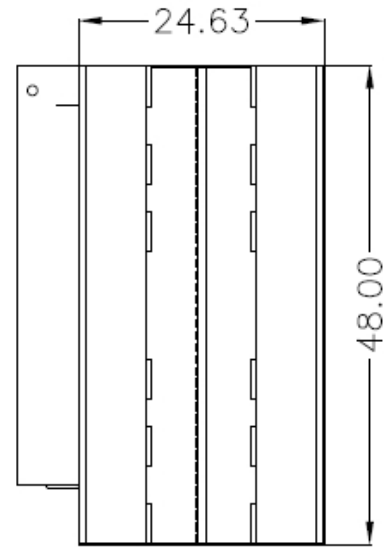

TOP VIEW  
(SHOWN LESS GRATE)

**CONSTRUCTION:** 12/14/16 Gauge steel cabinet finished with Powder-Coat finish. Includes a 10 gallon external dust drawer, 5" deep downdraft table (600 lbs table load) with removable back fence, removable end cap for easy access to filters, removable back panel for easy access to B.I. motor/blower, 25' 12 Ga. power cord, and on-off switch. Motor wired to junction box outside unit for 3 phase. Acoustical lining standard in blower compartment. Vibra-Pulse cleaning Standard.

**WEIGHT:** 346 lbs.  
**DOWNDRAFT VELOCITY:** 112 FPM with std. 1.5 HP motor  
 208 FPM with opt. 3 HP motor

**NOISE:** 76 dBA - 1.5 HP  
 82 dBA - 3 HP; 74 dBA w/silencer

**ELECTRICAL:**  
 1.5 HP 115 /208-230/1/60, 15/7.9-7.5 amps, std.  
 1.5 HP 208-230/460/3/60, 4.9-4.6/2.3 amps, opt.  
 3 HP 208-230/460/3/60, 8.4-8.0/4.0 amps, opt.

**FIRE SUPPRESSION:** Equipment provided by others.

**SPECIAL NOTES:** Compressed air filter provided by others.

**MAIN FILTERS:**  
 (2) Clean-2 Filter cartridge, 16"Dx12"  
 (2) Cartridge, FIBERDUST  
 (2) Cartridge, Spunbond  
 (2) Cartridge, Spark Resistant  
 (2) Cartridge, Spunbond - HO  
 (2) Cartridge, CleanPlus double treated fire retardant

**HEPA OPTION:**  (1) External HEPA filter, 99.97%

**AD OPTION:**  (1) External adsorber, 18 lb. capacity

**OTHER OPTIONS:**  
 Pressure gauge kit indicates filter changes  
 Auto Clean  
 Casters, increases table height by 3" to OA 36"  
 BF3 w/Light  
 Aluminum Grate  
 Vinyl Coated Grate  
 Fiberglass Grate  
 Regulator  
 Silencer (Adds 8" to depth of unit)

\* AFS FILTER EFFICIENCIES BASED ON ASHRAE 52-76 TEST METHOD

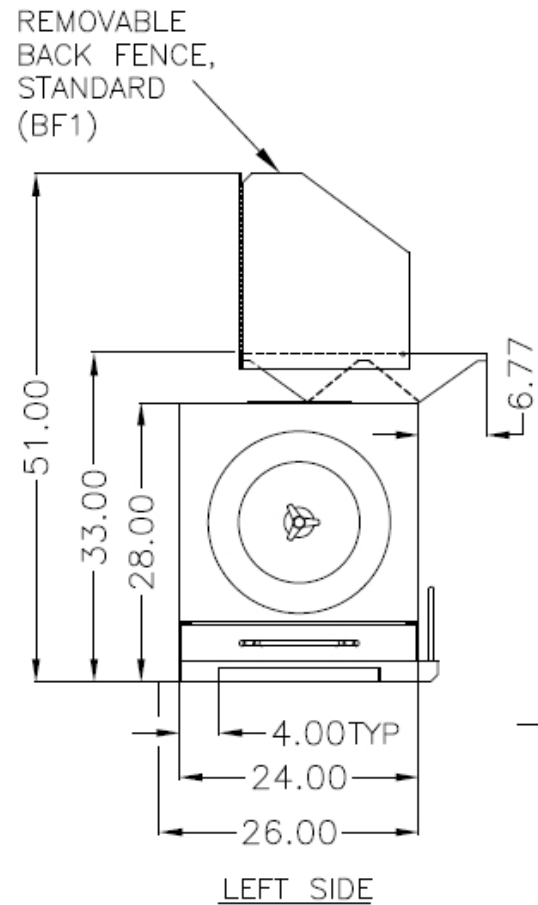

LEFT SIDE

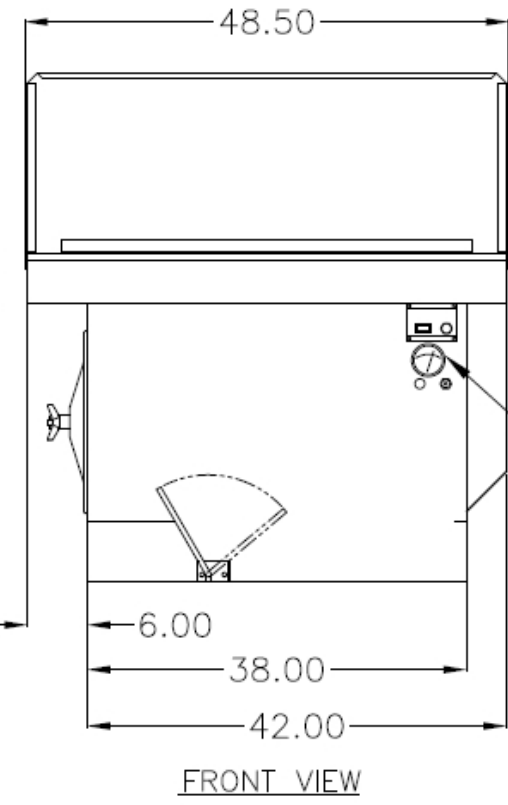

FRONT VIEW

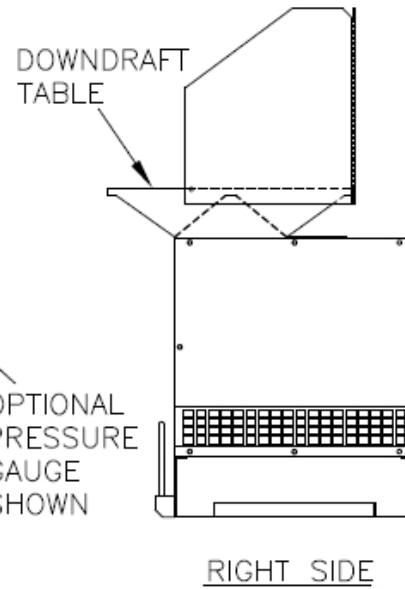

RIGHT SIDE

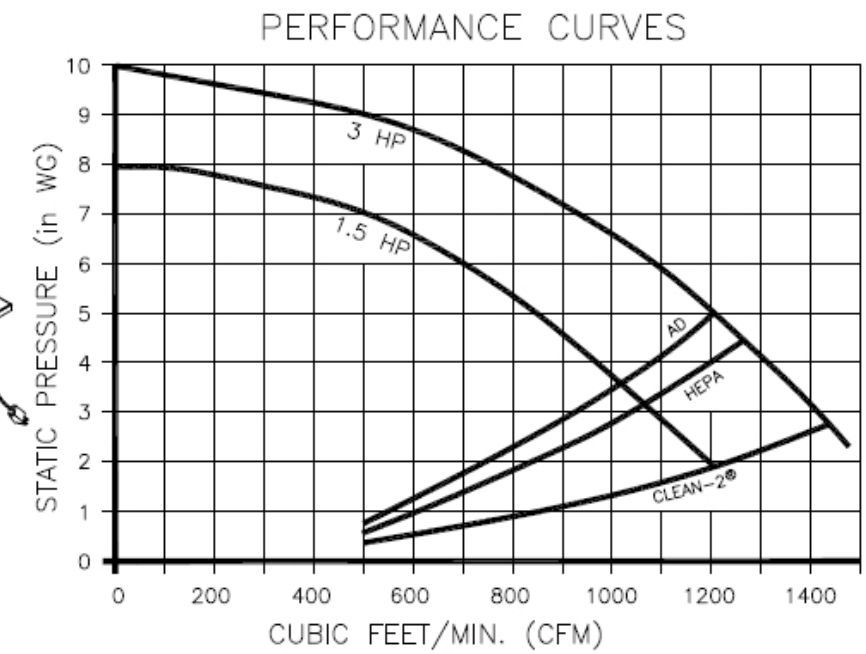
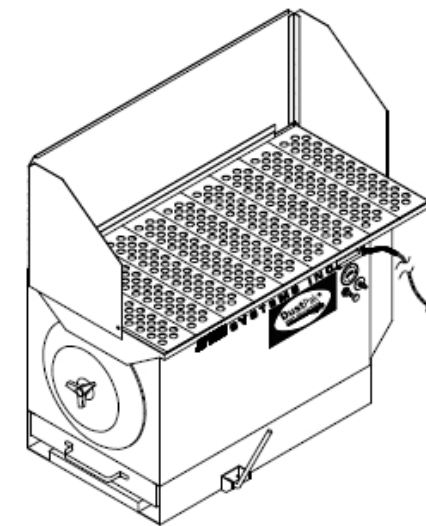

05-04

CUSTOMER:	
CUSTOMER P.O.:	
PROJECT:	
ENGINEER:	
SALES REP.:	
IDENTIFICATION / TAGGING:	

> [www.lev-co.com](http://www.lev-co.com) • 1.888.862.5356



The device depicted and described hereon embodies proprietary information owned by the manufacturer. All design, manufacturing, reproduction, sales and patent rights regarding this device or drawing reserved except where explicit right is guaranteed in writing. We reserve the right to make design changes.

Drawn by:	Janos B
Date:	5/1/2008
Scale:	NTS
Weight:	N/A

<b>05-04 DTH-1700 Downdraft Table</b>	
Specification Drawing	
Drawing No.: -	File Name: (05-04) DTH-1700 - SD
Material:	Product manufactured by: <b>Airflow SYSTEMS INC.</b>
	Sheet: 1/2

**MODELS & OPTIONS:**

**Part # Description**

**Main System / Part**

- DTH-1700-3HP-1 DTH-1700 downdraft table with a 3 HP TEFC motor 230-460/3/60 Hz
- DTH-1700-3HP-2 DTH-1700 downdraft table with a 3 HP TEFC motor 575-600/3/60 Hz

**Fan / Motor Upgrades or Options (when ordering main unit)**

- DTH1700-3HP-1PHASE 3 Hp TEFC, 230/1/ High Flow Blower Option for Standard DTH-1700 Unit
- DTH1700-3 PHASE 1.5Hp TEFC motor, 208-230\460\575\3\60 Hz, Std Blower Option for Standard DTH-1700 Unit
- DTH1700-3HP 3 HP TEFC motor, 208-230\460\575\3\60 Hz, High Flow Option for Standard DTH-1700 Unit
- DTH1700-1.5HP-EXP 1.5HP Explosion Proof option for DTH1700. Available in 1 phase or 3 phase - please specify when ordering.
- DTH1700-3HP-EXP 3HP Explosion Proof option for DTH1700 (3 phase only)

**Extraction Arms**

- P-002 Flexi© extraction arm 2m (6.7') for mounting to Mobi-Flex©.
- P-003 Flexi© extraction arm 3m (10') for mounting to Mobi-Flex©.
- FLEXI-BRACKET Mounting Bracket used to mount a Flexi I Extraction Arm on a DTH-1700&ALH-2

**Filter Options (when ordering main unit)**

- DTH1700-AD Internal AD Option for Standard DTH-1700 Unit
- DTH1700-EXAD External AD Filter Option for Standard DTH-1700 Unit
- DTH1700-EXDOP External 95% DOP Filter Option for Standard DTH-1700 Unit
- DTH1700-EXHE External 99.97% HEPA Filter Option for Standard DTH-1700 Unit
- DTH1700-FD Fiber dust Cartridge Filter Option for Standard DTH-1700 Unit
- DTH1700-UCP UltraClean Plus Cartridge Filter Option for Standard DTH-1700 Unit

**Preventative Maintenance Pressure Gauges, etc. (when ordering main unit)**

- DTH1700-PG-10 0-10" magna-helic pressure gauge, approximately 5" diameter size. Surface mounted.
- DTH1700-REG Regulator Gauge Option for Standard DTH-1700 Unit

**Misc. Options**

- DTH1700-ALUM Aluminum Grate Panels Option for Standard DTH-1700 Unit
- DTH1700-BF3/LIGHT 30" High, sides, back & top, with Dust-Free Light Option to replace standard 18" shields on standard DTH-1700 Unit
- DTH1700-CASTERS 8" Fixed & 5" Swivel Caster Option for Standard DTH-1700 Unit
- DTH1700-COATED Vinyl Coated Bar Grate Option for Standard DTH-1700 Unit
- DTH1700-FIBER Fiberglass Bar Grate Option for Standard DTH-1700 Unit
- DTH1700-TABLE EXT Table Extensions
- DTH1700-LESSVP Option to remove Vibra-Pulse cleaning system from standard DTH-1700 unit (deduct).

**Sound Attenuation**

- DTH1700-S-EXT External Silencer Option for Standard DTH-1700 Unit

**Localized Enclosures and Shields**

- DT-EN-2 Aluminum/Acrylic enclosure c/w top back and side acrylic panels for improved visibility & capture of fumes and dust (3'H X 48"W X 24"D)

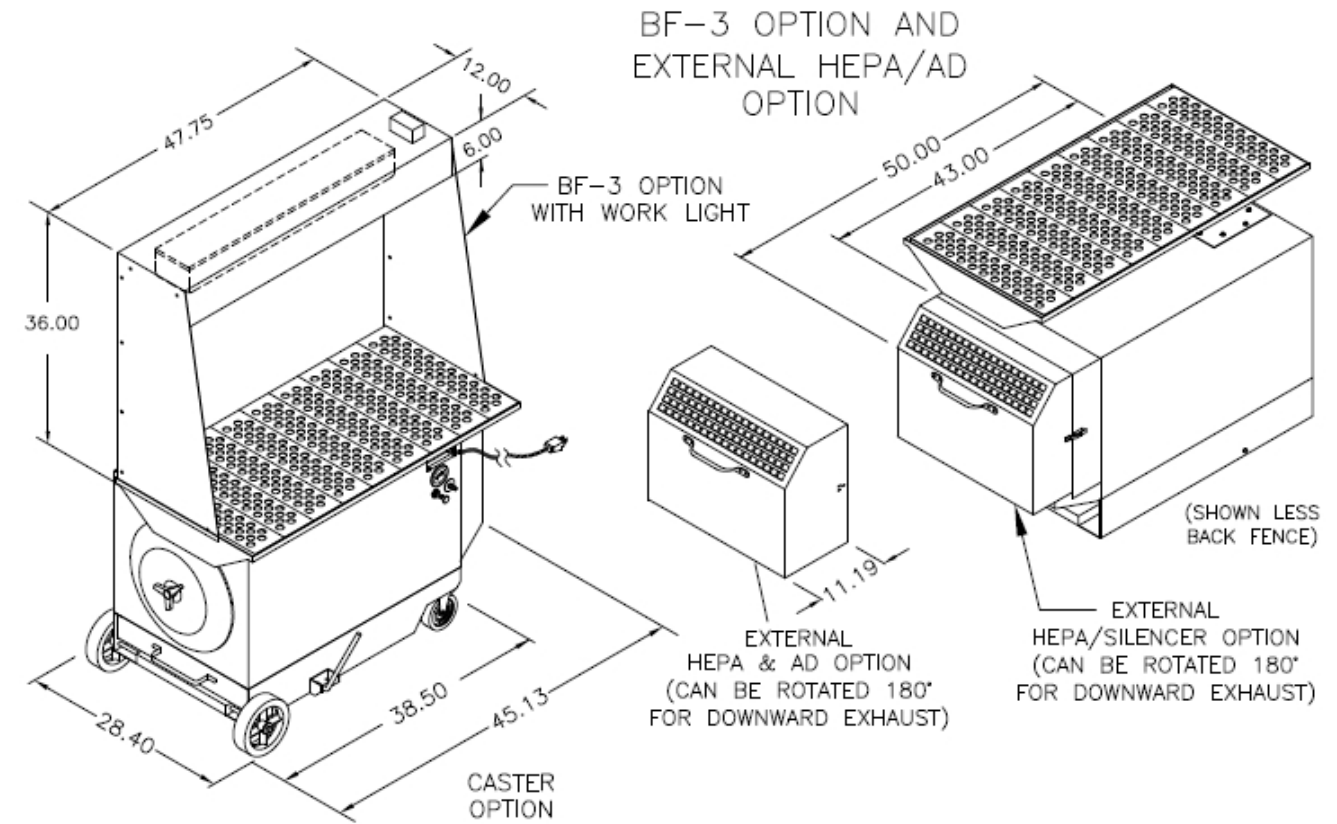

**Part # Description**

**Fan, Light & Other Electrical Accessories**

- DTH1700-AP-1 Offline Auto Pulse, 1 Phase Option for Standard DTH-1700 Unit
- DTH1700-AP-3 Offline Auto Pulse, 3 Phase Option for Standard DTH-1700 Unit

**Retro-Fit Parts**

- 2KT51733 External HEPA Retrofit Kit for PCH-1, PCH-2, DCH-1, DCH-2, DTH-800, DTH-1700
- 2KT51734 External AD Retrofit Kit for PCH-1, PCH-2, DCH-1, DCH-2, DTH-800, DTH-1700. Charcoal not included. Please order charcoal separately.
- 2KT51739 External HEPA & AD Retrofit Kit for PCH-1, PCH-2, DCH-1, DCH-2, DTH-800, DTH-1700. Charcoal not included. Please order charcoal separately.
- 2KT51768 External Silencer Retrofit Kit for PCH-1, PCH-2, DCH-1, DCH-2, DTH-800, DTH-1700

**05-04**

CUSTOMER:  
 CUSTOMER P.O.:  
 PROJECT:  
 ENGINEER:  
 SALES REP.:  
 IDENTIFICATION / TAGGING:

> [www.lev-co.com](http://www.lev-co.com) • 1.888.862.5356

**lev-co**

The device depicted and described hereon embodies proprietary information owned by the manufacturer. All design, manufacturing, reproduction, sales and patent rights regarding this device or drawing reserved except where explicit right is guaranteed in writing. We reserve the right to make design changes.

Drawn by: Janos B  
 Date: 5/1/2008  
 Scale: NTS  
 Weight: N/A

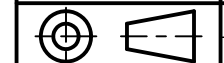

**05-04 DTH-1700  
 Downdraft Table**

Specification Drawing

Drawing No.: - File Name: (05-04) DTH-1700 - SD  
 Material: Product manufactured by: Sheet: 2/2

DUST COLLECTION • FUME EXTRACTION • OIL MIST FILTRATION • VEHICLE EXHAUST

