

QUICK LOCK PIPES

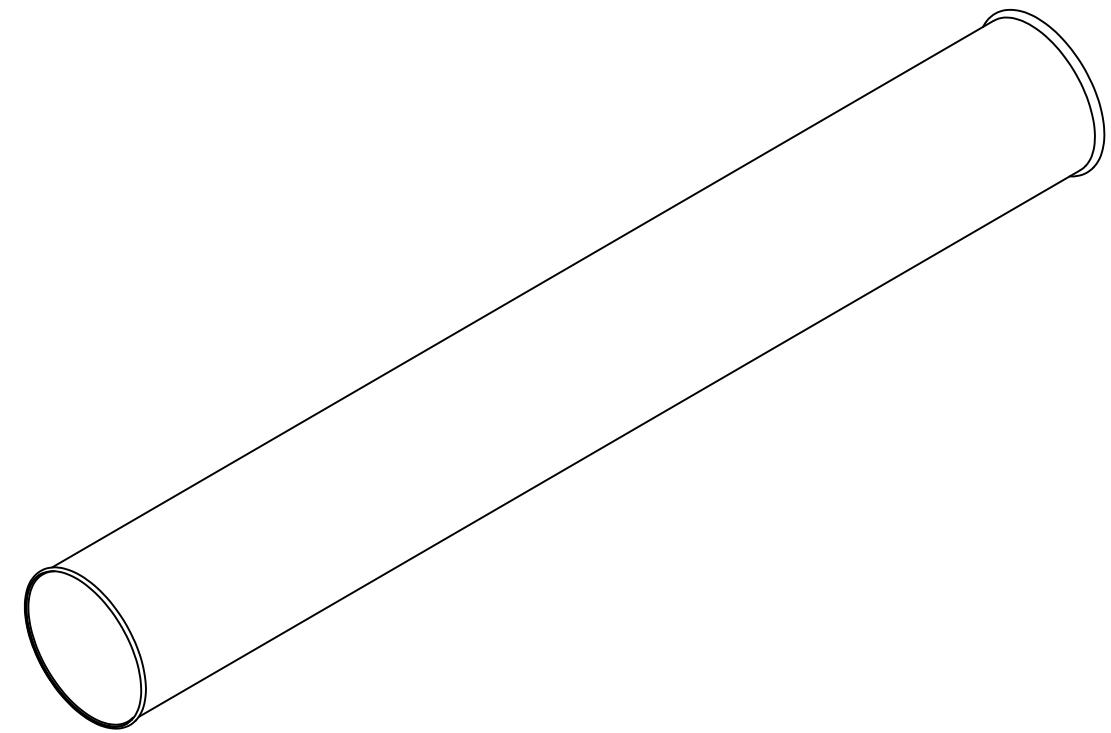
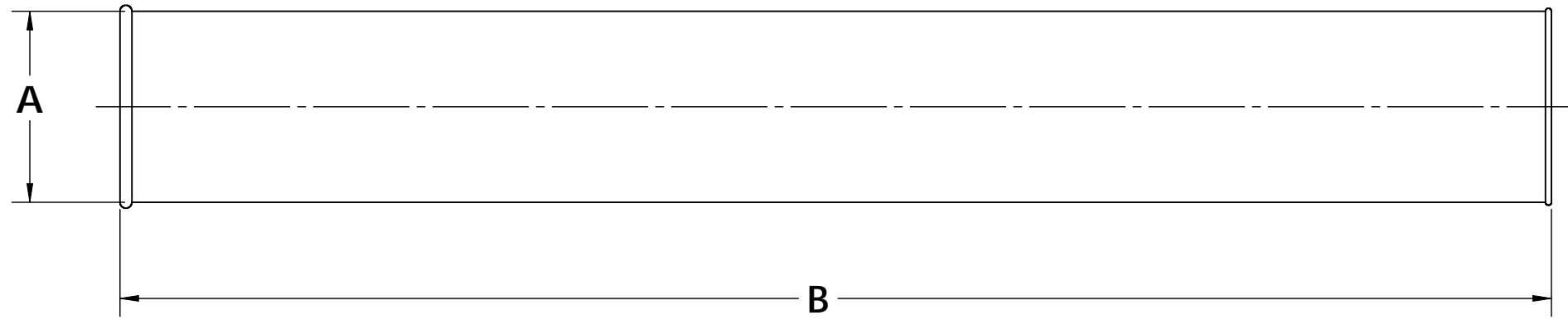

	PART #	DESCRIPTION	A	B
<input type="checkbox"/> ___	QL-PIPE-Ø03x39.25	Quick Lock Pipe	3	39.25
<input type="checkbox"/> ___	QL-PIPE-Ø04x47.25	Quick Lock Pipe	4	47.25
<input type="checkbox"/> ___	QL-PIPE-Ø05x47.25	Quick Lock Pipe	5	47.25
<input type="checkbox"/> ___	QL-PIPE-Ø06x59.25	Quick Lock Pipe	6	59.25
<input type="checkbox"/> ___	QL-PIPE-Ø07x59.25	Quick Lock Pipe	7	59.25
<input type="checkbox"/> ___	QL-PIPE-Ø08x59.25	Quick Lock Pipe	8	59.25
<input type="checkbox"/> ___	QL-PIPE-Ø09x59.25	Quick Lock Duct	9	59.25
<input type="checkbox"/> ___	QL-PIPE-Ø10x59.25	Quick Lock Duct	10	59.25
<input type="checkbox"/> ___	QL-PIPE-Ø11x59.25	Quick Lock Duct	11	59.25
<input type="checkbox"/> ___	QL-PIPE-Ø12x59.25	Quick Lock Duct	12	59.25

NOTE: Pipe is constructed in various materials with a welded longitudinal seam.

CUSTOMER:
 CUSTOMER P.O.:
 PROJECT:
 ENGINEER:
 SALES REP.:
 IDENTIFICATION / TAGGING:

> www.lev-co.com • 1.888.862.5356

lev-co

The device depicted and described hereon embodies proprietary information owned by the manufacturer. All design, manufacturing, reproduction, sales and patent rights regarding this device or drawing reserved except where explicit right is guaranteed in writing. We reserve the right to make design changes.

Drawn by: Janos B
 Date: 3/21/2008
 Scale: NTS
 Weight: N/A

Quick Lock Pipes & Fittings

Specification Drawing

Drawing No.: -
 Material: -

File Name: (17-01) Quick Lock Pipes & Fittings
 Sheet: 1/6



Quick Lock Flange Adapter

PART #	DESCRIPTION	DIMENSIONS	A
<input type="checkbox"/> QL-FLADP-Ø03x4	Quick Lock Flange Adapter	Ø3x4"	3
<input type="checkbox"/> QL-FLADP-Ø04x4	Quick Lock Flange Adapter	Ø4x4"	4
<input type="checkbox"/> QL-FLADP-Ø05x4	Quick Lock Flange Adapter	Ø5x4"	5
<input type="checkbox"/> QL-FLADP-Ø06x4	Quick Lock Flange Adapter	Ø6x4"	6
<input type="checkbox"/> QL-FLADP-Ø07x4	Quick Lock Flange Adapter	Ø7x4"	7
<input type="checkbox"/> QL-FLADP-Ø08x4	Quick Lock Flange Adapter	Ø8x4"	8
<input type="checkbox"/> QL-FLADP-Ø09x4	Quick Lock Flange Adapter	Ø9x4"	9
<input type="checkbox"/> QL-FLADP-Ø10x4	Quick Lock Flange Adapter	Ø10x4"	10
<input type="checkbox"/> QL-FLADP-Ø11x4	Quick Lock Flange Adapter	Ø11x4"	11
<input type="checkbox"/> QL-FLADP-Ø12x4	Quick Lock Flange Adapter	Ø12x4"	12

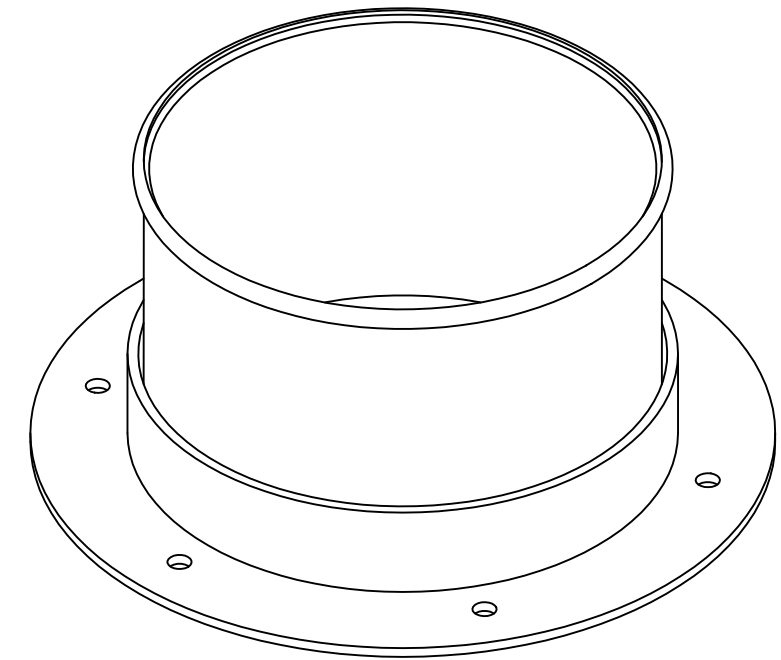
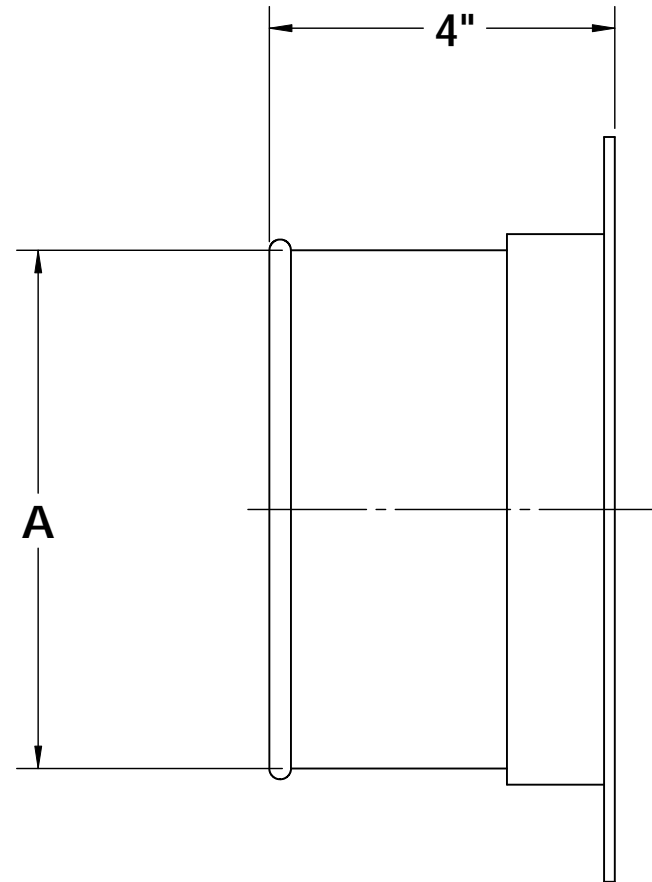

**NOTE: - Flat flange blank if hole pattern is not provided
- Please specify hole pattern**

CUSTOMER:
CUSTOMER P.O.:
PROJECT:
ENGINEER:
SALES REP.:
IDENTIFICATION / TAGGING:

> www.lev-co.com • 1.888.862.5356

lev-co

The device depicted and described hereon embodies proprietary information owned by the manufacturer. All design, manufacturing, reproduction, sales and patent rights regarding this device or drawing reserved except where explicit right is guaranteed in writing. We reserve the right to make design changes.

Drawn by: Janos B
Date: 3/21/2008
Scale: NTS
Weight: N/A

Quick Lock Pipes & Fittings

Specification Drawing

Drawing No.: -
Material: -

File Name: (17-01) Quick Lock Pipes & Fittings
Sheet: 2/6

PRESS FORMED ELBOW

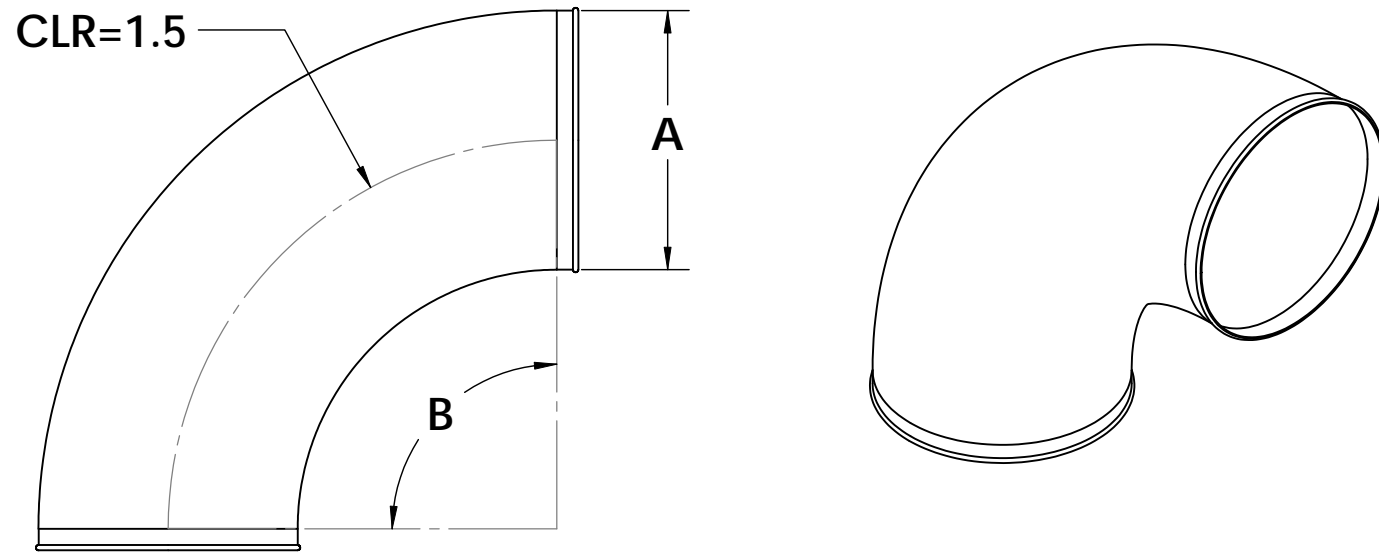

PART #	DESCRIPTION	A	B
<input type="checkbox"/> QL-ELB-Ø03x45°	Quick Lock Elbow @ 45° - 1.5 CLR	3	45°
<input type="checkbox"/> QL-ELB-Ø04x45°	Quick Lock Elbow @ 45° - 1.5 CLR	4	45°
<input type="checkbox"/> QL-ELB-Ø05x45°	Quick Lock Elbow @ 45° - 1.5 CLR	5	45°
<input type="checkbox"/> QL-ELB-Ø06x45°	Quick Lock Elbow @ 45° - 1.5 CLR	6	45°
<input type="checkbox"/> QL-ELB-Ø07x45°	Quick Lock Elbow @ 45° - 1.5 CLR	7	45°
<input type="checkbox"/> QL-ELB-Ø08x45°	Quick Lock Elbow @ 45° - 1.5 CLR	8	45°
<input type="checkbox"/> QL-ELB-Ø09x45°	Quick Lock Elbow @ 45° - 1.5 CLR	9	45°
<input type="checkbox"/> QL-ELB-Ø10x45°	Quick Lock Elbow @ 45° - 1.5 CLR	10	45°
<input type="checkbox"/> QL-ELB-Ø11x45°	Quick Lock Elbow @ 45° - 1.5 CLR	11	45°
<input type="checkbox"/> QL-ELB-Ø12x45°	Quick Lock Elbow @ 45° - 1.5 CLR	12	45°

PART #	DESCRIPTION	A	B
<input type="checkbox"/> QL-ELB-Ø03x90°	Quick Lock Elbow @ 90° - 1.5 CLR	3	90°
<input type="checkbox"/> QL-ELB-Ø04x90°	Quick Lock Elbow @ 90° - 1.5 CLR	4	90°
<input type="checkbox"/> QL-ELB-Ø05x90°	Quick Lock Elbow @ 90° - 1.5 CLR	5	90°
<input type="checkbox"/> QL-ELB-Ø06x90°	Quick Lock Elbow @ 90° - 1.5 CLR	6	90°
<input type="checkbox"/> QL-ELB-Ø07x90°	Quick Lock Elbow @ 90° - 1.5 CLR	7	90°
<input type="checkbox"/> QL-ELB-Ø08x90°	Quick Lock Elbow @ 90° - 1.5 CLR	8	90°
<input type="checkbox"/> QL-ELB-Ø09x90°	Quick Lock Elbow @ 90° - 1.5 CLR	9	90°
<input type="checkbox"/> QL-ELB-Ø10x90°	Quick Lock Elbow @ 90° - 1.5 CLR	10	90°
<input type="checkbox"/> QL-ELB-Ø11x90°	Quick Lock Elbow @ 90° - 1.5 CLR	11	90°
<input type="checkbox"/> QL-ELB-Ø12x90°	Quick Lock Elbow @ 90° - 1.5 CLR	12	90°

SEGMENTED ELBOW

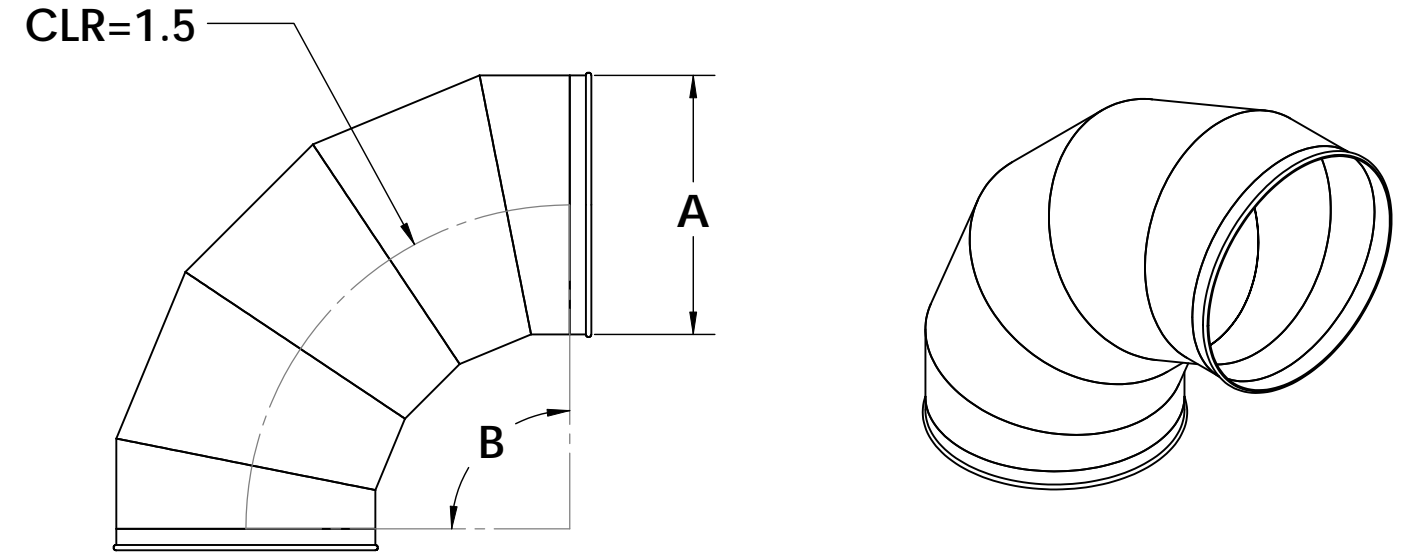

PART #	DESCRIPTION	A	B
<input type="checkbox"/> QL-ELB-Ø03x45°	Quick Lock Elbow @ 45° - 1.5 CLR	3	45°
<input type="checkbox"/> QL-ELB-Ø04x45°	Quick Lock Elbow @ 45° - 1.5 CLR	4	45°
<input type="checkbox"/> QL-ELB-Ø05x45°	Quick Lock Elbow @ 45° - 1.5 CLR	5	45°
<input type="checkbox"/> QL-ELB-Ø06x45°	Quick Lock Elbow @ 45° - 1.5 CLR	6	45°
<input type="checkbox"/> QL-ELB-Ø07x45°	Quick Lock Elbow @ 45° - 1.5 CLR	7	45°
<input type="checkbox"/> QL-ELB-Ø08x45°	Quick Lock Elbow @ 45° - 1.5 CLR	8	45°
<input type="checkbox"/> QL-ELB-Ø09x45°	Quick Lock Elbow @ 45° - 1.5 CLR	9	45°
<input type="checkbox"/> QL-ELB-Ø10x45°	Quick Lock Elbow @ 45° - 1.5 CLR	10	45°
<input type="checkbox"/> QL-ELB-Ø11x45°	Quick Lock Elbow @ 45° - 1.5 CLR	11	45°
<input type="checkbox"/> QL-ELB-Ø12x45°	Quick Lock Elbow @ 45° - 1.5 CLR	12	45°

PART #	DESCRIPTION	A	B
<input type="checkbox"/> QL-ELB-Ø03x90°	Quick Lock Elbow @ 90° - 1.5 CLR	3	90°
<input type="checkbox"/> QL-ELB-Ø04x90°	Quick Lock Elbow @ 90° - 1.5 CLR	4	90°
<input type="checkbox"/> QL-ELB-Ø05x90°	Quick Lock Elbow @ 90° - 1.5 CLR	5	90°
<input type="checkbox"/> QL-ELB-Ø06x90°	Quick Lock Elbow @ 90° - 1.5 CLR	6	90°
<input type="checkbox"/> QL-ELB-Ø07x90°	Quick Lock Elbow @ 90° - 1.5 CLR	7	90°
<input type="checkbox"/> QL-ELB-Ø08x90°	Quick Lock Elbow @ 90° - 1.5 CLR	8	90°
<input type="checkbox"/> QL-ELB-Ø09x90°	Quick Lock Elbow @ 90° - 1.5 CLR	9	90°
<input type="checkbox"/> QL-ELB-Ø10x90°	Quick Lock Elbow @ 90° - 1.5 CLR	10	90°
<input type="checkbox"/> QL-ELB-Ø11x90°	Quick Lock Elbow @ 90° - 1.5 CLR	11	90°
<input type="checkbox"/> QL-ELB-Ø12x90°	Quick Lock Elbow @ 90° - 1.5 CLR	12	90°

CUSTOMER:
 CUSTOMER P.O.:
 PROJECT:
 ENGINEER:
 SALES REP.:
 IDENTIFICATION / TAGGING:

> www.lev-co.com • 1.888.862.5356

lev-co

The device depicted and described hereon embodies proprietary information owned by the manufacturer. All design, manufacturing, reproduction, sales and patent rights regarding this device or drawing reserved except where explicit right is guaranteed in writing. We reserve the right to make design changes.

Drawn by: Janos B
 Date: 3/21/2008
 Scale: NTS
 Weight: N/A

Quick Lock Pipes & Fittings

Specification Drawing

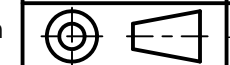

Drawing No.: -
 Material: -

File Name: (17-01) Quick Lock Pipes & Fittings
 Sheet: 3/6

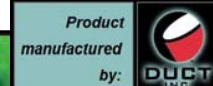

Quick Lock Branch @45°

PART #	DESCRIPTION	A
<input type="checkbox"/> QL-BR-Ø03x45°	Quick Lock Branch @45°	3
<input type="checkbox"/> QL-BR-Ø04x45°	Quick Lock Branch @45°	4
<input type="checkbox"/> QL-BR-Ø05x45°	Quick Lock Branch @45°	5
<input type="checkbox"/> QL-BR-Ø06x45°	Quick Lock Branch @45°	6
<input type="checkbox"/> QL-BR-Ø07x45°	Quick Lock Branch @45°	7
<input type="checkbox"/> QL-BR-Ø08x45°	Quick Lock Branch @45°	8
<input type="checkbox"/> QL-BR-Ø09x45°	Quick Lock Branch @45°	9
<input type="checkbox"/> QL-BR-Ø10x45°	Quick Lock Branch @45°	10
<input type="checkbox"/> QL-BR-Ø11x45°	Quick Lock Branch @45°	11
<input type="checkbox"/> QL-BR-Ø12x45°	Quick Lock Branch @45°	12
<input type="checkbox"/> QL-BR-Ø13x45°	Quick Lock Branch @45°	13
<input type="checkbox"/> QL-BR-Ø14x45°	Quick Lock Branch @45°	14
<input type="checkbox"/> QL-BR-Ø15x45°	Quick Lock Branch @45°	15
<input type="checkbox"/> QL-BR-Ø16x45°	Quick Lock Branch @45°	16
<input type="checkbox"/> QL-BR-Ø17x45°	Quick Lock Branch @45°	17
<input type="checkbox"/> QL-BR-Ø18x45°	Quick Lock Branch @45°	18
<input type="checkbox"/> QL-BR-Ø20x45°	Quick Lock Branch @45°	20
<input type="checkbox"/> QL-BR-Ø22x45°	Quick Lock Branch @45°	22
<input type="checkbox"/> QL-BR-Ø24x45°	Quick Lock Branch @45°	24

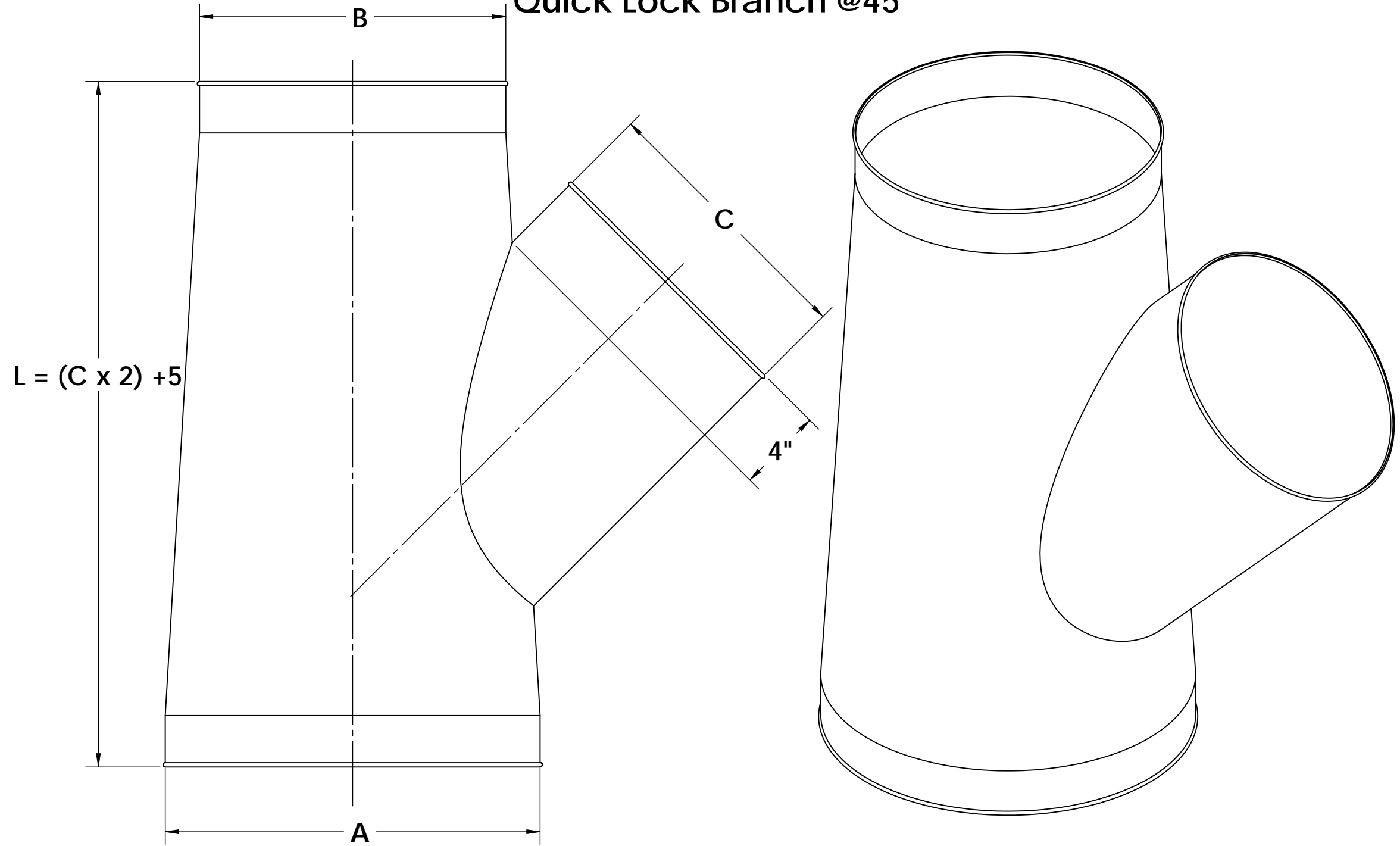

NOTES: - Specify A-B-C dimensions when ordering.
 - Size by "A" dimension.

CUSTOMER:
 CUSTOMER P.O.:
 PROJECT:
 ENGINEER:
 SALES REP.:
 IDENTIFICATION / TAGGING:

> www.lev-co.com • 1.888.862.5356

lev-co

The device depicted and described hereon embodies proprietary information owned by the manufacturer. All design, manufacturing, reproduction, sales and patent rights regarding this device or drawing reserved except where explicit right is guaranteed in writing. We reserve the right to make design changes.

Drawn by: Janos B
 Date: 3/21/2008
 Scale: NTS
 Weight: N/A

Quick Lock Pipes & Fittings
Specification Drawing

Drawing No.: -
 Material: -
 File Name: (17-01) Quick Lock Pipes & Fittings
 Sheet: 4/6

Quick Lock Slip Joint

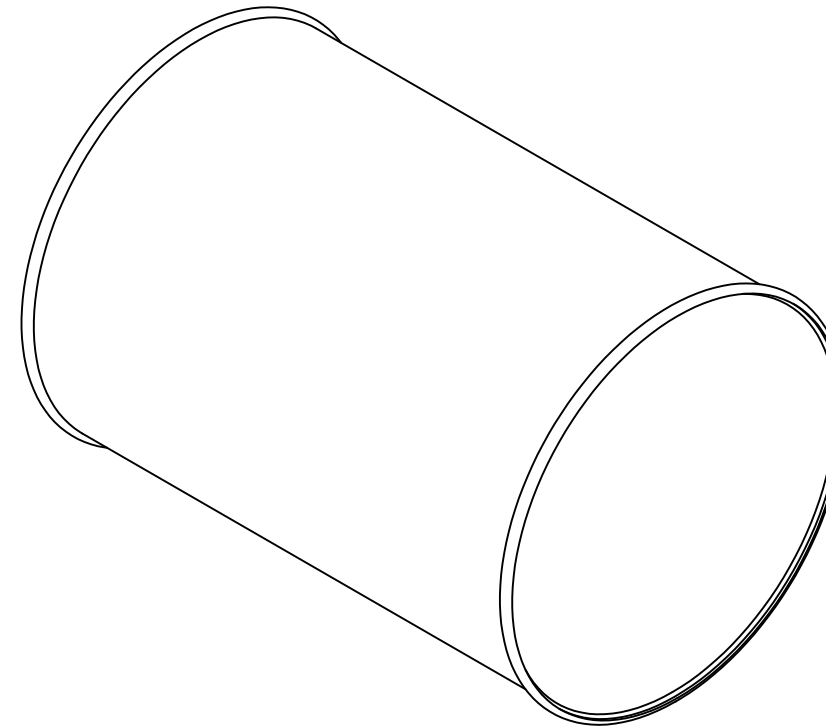
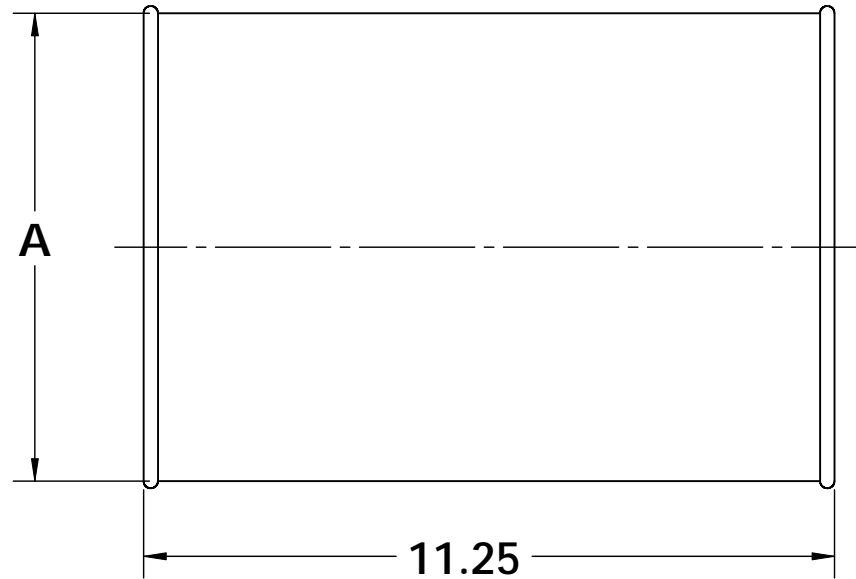

	PART #	DESCRIPTION	A
<input type="checkbox"/>	QL-SLJNT-Ø03x11.25	Quick Lock Slip Joint	3
<input type="checkbox"/>	QL-SLJNT-Ø04x11.25	Quick Lock Slip Joint	4
<input type="checkbox"/>	QL-SLJNT-Ø05x11.25	Quick Lock Slip Joint	5
<input type="checkbox"/>	QL-SLJNT-Ø06x11.25	Quick Lock Slip Joint	6
<input type="checkbox"/>	QL-SLJNT-Ø07x11.25	Quick Lock Slip Joint	7
<input type="checkbox"/>	QL-SLJNT-Ø08x11.25	Quick Lock Slip Joint	8
<input type="checkbox"/>	QL-SLJNT-Ø09x11.25	Quick Lock Slip Joint	9
<input type="checkbox"/>	QL-SLJNT-Ø10x11.25	Quick Lock Slip Joint	10
<input type="checkbox"/>	QL-SLJNT-Ø11x11.25	Quick Lock Slip Joint	11
<input type="checkbox"/>	QL-SLJNT-Ø12x11.25	Quick Lock Slip Joint	12

NOTE: The Slip Joint is constructed in various materials with a welded longitudinal seam.

CUSTOMER:
 CUSTOMER P.O.:
 PROJECT:
 ENGINEER:
 SALES REP.:
 IDENTIFICATION / TAGGING:

> www.lev-co.com • 1.888.862.5356

lev-co

The device depicted and described hereon embodies proprietary information owned by the manufacturer. All design, manufacturing, reproduction, sales and patent rights regarding this device or drawing reserved except where explicit right is guaranteed in writing. We reserve the right to make design changes.

Drawn by: Janos B
 Date: 3/21/2008
 Scale: NTS
 Weight: N/A



Quick Lock Pipes & Fittings

Specification Drawing

Drawing No.: -
 Material: -
 File Name: (17-01) Quick Lock Pipes & Fittings
 Sheet: 5/6



Quick Lock Standard Clamp

	PART #	DESCRIPTION	DIAMETER INCHES
<input type="checkbox"/>	QL-STDCL-Ø03	Standard Quick Lock Clamp	3
<input type="checkbox"/>	QL-STDCL-Ø04	Standard Quick Lock Clamp	4
<input type="checkbox"/>	QL-STDCL-Ø05	Standard Quick Lock Clamp	5
<input type="checkbox"/>	QL-STDCL-Ø06	Standard Quick Lock Clamp	6
<input type="checkbox"/>	QL-STDCL-Ø07	Standard Quick Lock Clamp	7
<input type="checkbox"/>	QL-STDCL-Ø08	Standard Quick Lock Clamp	8
<input type="checkbox"/>	QL-STDCL-Ø09	Standard Quick Lock Clamp	9
<input type="checkbox"/>	QL-STDCL-Ø10	Standard Quick Lock Clamp	10
<input type="checkbox"/>	QL-STDCL-Ø11	Standard Quick Lock Clamp	11
<input type="checkbox"/>	QL-STDCL-Ø12	Standard Quick Lock Clamp	12

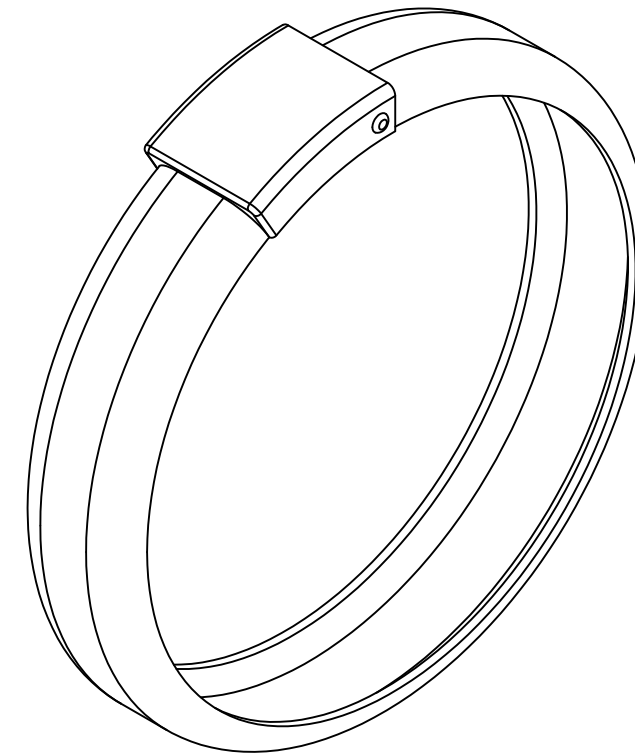

- NOTES:**
- Clamps are constructed in various materials and come complete with locking pin.
 - Gasket material surrounds inside of clamp for secure connection.
 - Alternative seals are available.

CUSTOMER:
 CUSTOMER P.O.:
 PROJECT:
 ENGINEER:
 SALES REP.:
 IDENTIFICATION / TAGGING:

www.lev-co.com • 1.888.862.5356



The device depicted and described hereon embodies proprietary information owned by the manufacturer. All design, manufacturing, reproduction, sales and patent rights regarding this device or drawing reserved except where explicit right is guaranteed in writing. We reserve the right to make design changes.

Drawn by: Janos B
 Date: 3/21/2008
 Scale: NTS
 Weight: N/A

Quick Lock Pipes & Fittings	
Specification Drawing	
Drawing No.: -	File Name: (17-01) Quick Lock Pipes & Fittings
Material: -	Sheet: 6/6

