

**SPECIFICATIONS:**

**CONSTRUCTION:** 18 Gauge painted steel cabinet with Ultra-Seal™ filter mounting system. Includes filter access thru removable side panel, on-off switch on unit, and remote wall switch with plate and running light. Eye bolts furnished. Motor wired to junction box on inside of unit.

**WEIGHT:** 117 lbs.

**AIRFLOW:** 1000 CFM (HI), 750 CFM (LOW)

**ELECTRICAL:**  1/2 HP, 115/1/60, 7.4 amps, 2 speed, std.

**FILTER SEAL:** Ultra-Seal, welded picture frame with positive sealing filter locking mechanism for all main filters, HEPA filter and adsorber modules (when used). Slide in tracks shall be used for prefilters only.

**FIRE SUPPRESSION:** Equipment provided by others.

**PREFILTERS:**  (1) 2" polyester, std.

**MAIN FILTERS:**  (1) 39 ft<sup>2</sup> multi-pocket 95%, std.  
 18 ft<sup>2</sup> 95% short bag filter and 99.97% HEPA, opt.

**AFTER FILTERS:**  (1) 1/2" charcoal, std.  
 2" charcoal, opt.

**AD OPTION:**  (1) 20 lb. adsorber modules, refillable, with 2" polyester prefilter, 2" final pleated filter, and 95% short bag filter, opt.

**ODOR/EX:**  deodorizer cartridge

**OTHER OPTIONS:**  (2) inlets, (2) outlets

\* AFS FILTER EFFICIENCIES BASED ON ASHRAE 52-76 TEST METHOD

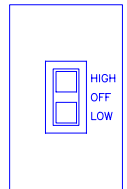

REMOTE WALL SWITCH

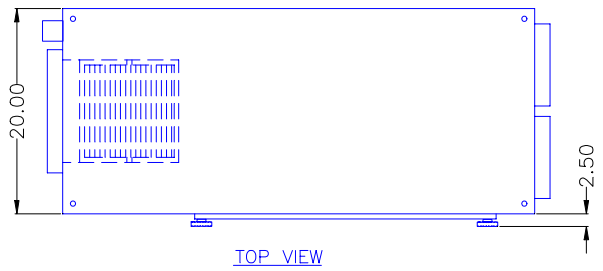

TOP VIEW

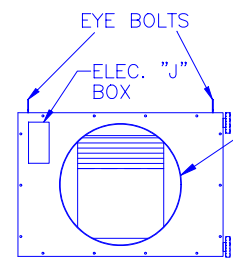

BACK VIEW

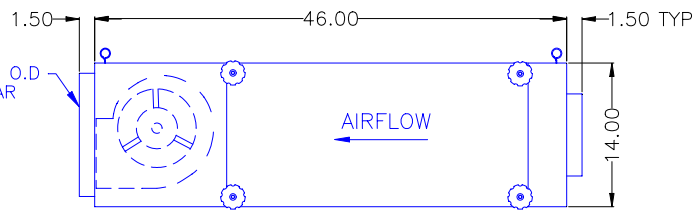

SIDE VIEW

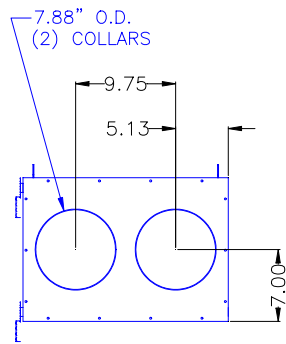

INLET VIEW

PERFORMANCE CURVES

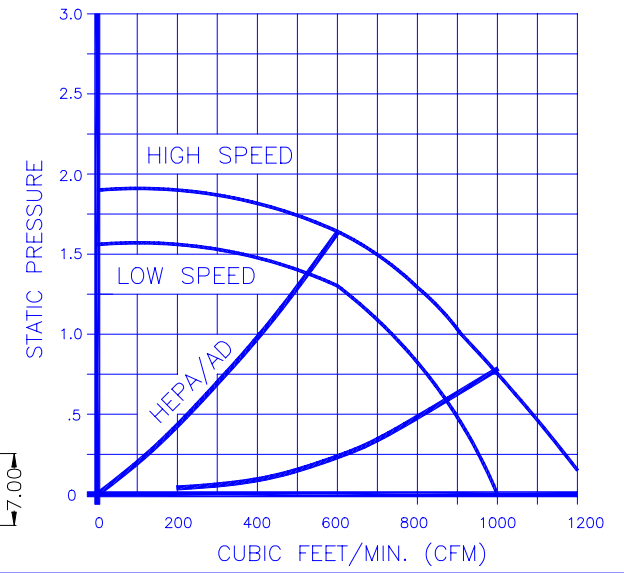

**NOTES:**  
 ITEMS DESIGNATED AS  ARE INCLUDED IN THIS PROPOSAL.

THE DEVICE DEPICTED AND DESCRIBED HEREON EMBODIES PROPRIETARY INFORMATION OWNED BY AIRFLOW SYSTEMS, INC. ALL DESIGN, MANUFACTURING, REPRODUCTION, SALES, AND PATENT RIGHTS REGARDING THIS DEVICE OR DRAWING ARE RESERVED EXCEPT WHERE EXPLICIT RIGHT IS GRANTED IN WRITING.		<b>Airflow</b> ® <b>SYSTEMS INC.</b>		For more information, please contact: <b>LEV-CO</b> 1.888.862.5356 www.lev-co.com
DRAWN BY CB	DATE 4-1-99	TITLE MODEL 1000-D	DRAWING NO.: 1000DSPC (00-2087/D)	